

Features:

- Compact design and Very easy to Install
- No. of Lines can be made as per customer requirements
- Models with various Voltages, Currents and pairs available

Applications:

- Electrical/Electronic Equipment
- Shielded Rooms
- Low Power Source

Performance Indicator:

| Standard | High | Very High |
|----------|------|-----------|
| | | |

DATASHEET

AC CONTROL LINE FILTER – CMF94C

A range of multi-line filters suitable for filtering AC control lines and low current power lines on shielded rooms and general installations. All of these filters available with transient suppression also.

Technical Specifications:

| | |
|-----------------------------|--|
| Operating Voltage | : 250VAC |
| Current Rating | : 10A |
| Test Voltage | : 2250VDC |
| Insulation Resistance | : >100MΩ (Without Discharge Resistors) |
| Insertion Loss | : 100dB from 100KHz to 10GHz |
| Operating Temperature Range | : -40°C to +50°C |
| Storage Temperature Range | : -40°C to +85°C |
| Max. Surge current | : 6.5kA@8/20μs (Optional) |
| Enclosure Material | : CRCA with Plating |
| Finish | : Paint/Powder Coating |

Ordering Information:

| Model Number | Part Number | Model Number | Part Number | Number of Lines | Termination | | Min. Weight (Kgs) |
|--------------|-------------|---------------|-------------|-----------------|---------------|--------------------------------------|-------------------|
| | | | | | Input | Output | |
| CMF94C-2-10 | E111607-1 | CMF94CS-2-10 | E112848-1 | 2 | MIL Connector | Shielded Cable through Threaded Pipe | 5 |
| CMF94C-4-10 | E111608-1 | CMF94CS-4-10 | E112849-1 | 4 | MIL Connector | Shielded Cable through Threaded Pipe | 6 |
| CMF94C-5-10 | E111609-1 | CMF94CS-5-10 | E112850-1 | 6 | MIL Connector | Shielded Cable through Threaded Pipe | 8 |
| CMF94C-6-10 | E111610-1 | CMF94CS-6-10 | E112851-1 | 8 | MIL Connector | Shielded Cable through Threaded Pipe | 10 |
| CMF94C-7-10 | E112710-1 | CMF94CS-7-10 | E112852-1 | 12 | MIL Connector | Shielded Cable through Threaded Pipe | 18 |
| CMF94C-8-10 | E112711-1 | CMF94CS-8-10 | E112853-1 | 16 | MIL Connector | Shielded Cable through Threaded Pipe | 18 |
| CMF94C-9-10 | E112712-1 | CMF94CS-9-10 | E112854-1 | 24 | MIL Connector | Shielded Cable through Threaded Pipe | 25 |
| CMF94C-10-10 | E112713-1 | CMF94CS-10-10 | E112855-1 | 32 | MIL Connector | Shielded Cable through Threaded Pipe | 25 |

CMF94CS – With Surge Suppressor

Mechanical Drawing:

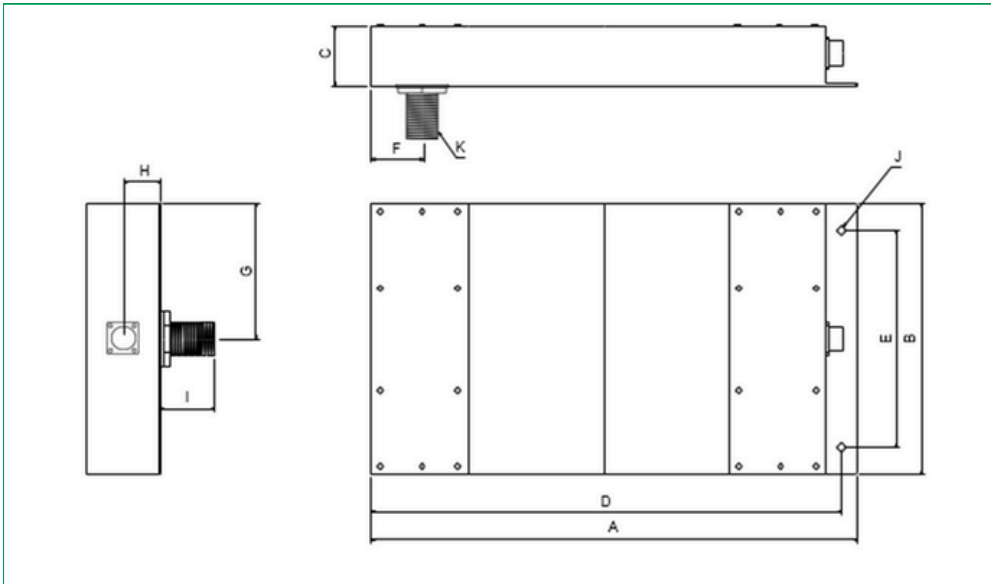

Mechanical Dimensions:

| Model Number | A | B | C | D | E | F | G | H | I | J | K |
|--------------|-----|-----|-----|-----|-----|----|-----|------|-----|-----|-----|
| CMF94C-2-10 | 350 | 90 | 45 | 335 | 70 | 40 | 45 | 21.5 | 100 | 6.5 | M25 |
| CMF94C-4-10 | 350 | 180 | 45 | 335 | 140 | 40 | 90 | 21.5 | 100 | 6.5 | M30 |
| CMF94C-5-10 | 350 | 270 | 45 | 335 | 210 | 40 | 135 | 21.5 | 100 | 6.5 | M30 |
| CMF94C-6-10 | 350 | 360 | 45 | 335 | 280 | 40 | 180 | 21.5 | 100 | 6.5 | M30 |
| CMF94C-7-10 | 350 | 360 | 90 | 335 | 280 | 40 | 180 | 45 | 100 | 8.5 | M30 |
| CMF94C-8-10 | 350 | 360 | 90 | 335 | 280 | 40 | 180 | 45 | 100 | 8.5 | M30 |
| CMF94C-9-10 | 350 | 360 | 180 | 335 | 280 | 40 | 180 | 90 | 100 | 8.5 | M40 |
| CMF94C-10-10 | 350 | 360 | 180 | 335 | 280 | 40 | 180 | 90 | 100 | 8.5 | M40 |

Note: All dimensions in mm; Tolerances according to ISO2768-C

Insertion Loss Graph:

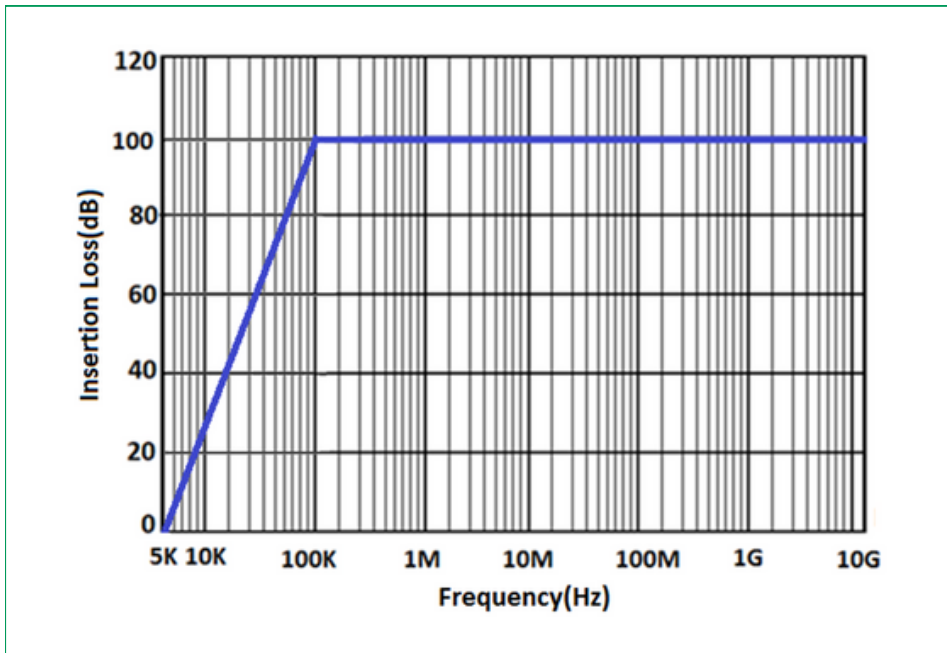

Accessories :

1. Mating Connector - 1 No
2. Plain Washer - 2 No's
3. Hex Nut - 2 No's
4. Gasket - 2 No's