

Features:

- Wide range of capacitance.
- High contact reliability.
- Easy to install.
- High quality and Reliability.
- Good Corrosion resistant.

Applications:

- Broadband interference suppression for shielded rooms.
- Telephone exchanges, base stations.
- Electrical machines and systems.
- UPS.
- RF power supplies/Switching power supplies.
- Power amplifiers and generators.

DATA SHEET
AC FEEDTHROUGH CAPACITOR
Description

Feed through Capacitors provide significant Insertion loss over a wide range of frequency up to 1GHz. Construction of Feedthrough Capacitors results in an excellent performance.

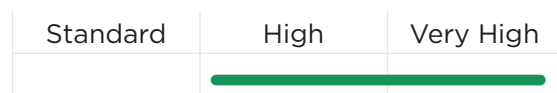
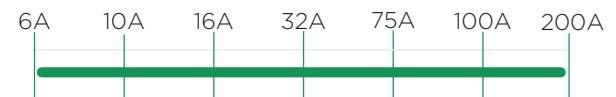
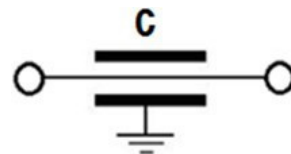
Performance Indicator

Rated current [A]

Typical circuit Diagram

Technical Specifications:

Max. Operating Voltage	: 250VAC/250VDC
Operating Frequency	: 50/60 Hz
Rated Current	: 6A to 200A @60°C
High Potential Test Voltage	: 3000VDC Line to Case For 2 sec
Capacitance Class	: Y2
Design Corresponding to	: IEC/EN60384-14
Flammability Corresponding To	: UL 94 V-0 or better
Temperature Range	: -40°C to+100°C (40/100/21)

Ordering Information

Model Number	Part Number	Current Rating @60°C	Leakage Current (mA) @250 VAC/50Hz	Capacitance (nF)±20%	A	B	C	D	E	F	T1	T2	M	N	Approx Weight (kg)
FTCAC-002N2-006A	E109743-1	6A	0.25	2.2	70	15.8	25	10	20	13	M3	M10	10.3	-	0.1
FTCAC-002N2-010A	E106651-1	10A			70	15.8	25	10	20	13	M3	M10	10.3	-	0.1
FTCAC-004N7-006A	E109744-1	6A	0.5	4.7	70	20	25	10	21	13	M3	M10	10.3	-	0.2
FTCAC-004N7-010A	E106652-1	10A			70	20	25	10	21	13	M3	M10	10.3	-	0.2
FTCAC-004N7-016A	E106653-1	16A			77	20	25	12	24	17	M4	M12	12.3	-	0.2
FTCAC-004N7-032A	E106654-1	32A			80	20	25	12	27	17	M5	M12	12.3	-	0.2
FTCAC-0010N-006A	E109745-1	6A	1.0	10	70	20	25	10	21	13	M3	M10	10.3	-	0.2
FTCAC-0010N-010A	E109746-1	10A			70	20	25	10	21	13	M3	M10	10.3	-	0.2
FTCAC-0010N-016A	E106655-1	16A			77	20	25	12	24	17	M4	M12	12.3	-	0.2
FTCAC-0010N-032A	E106656-1	32A			80	20	25	12	27	17	M5	M12	12.3	-	0.2
FTCAC-0010N-063A	E109747-1	63A			98	25	25	14	33	22	M6	M16	16.3	14.3	0.2
FTCAC-0010N-075A	E109748-1	75A			108	25	25	14	37	22	M8	M16	16.3	14.3	0.25
FTCAC-0022N-016A	E106657-1	16A	2.5	22	77	28	25	12	25	17	M4	M12	12.3	-	0.25
FTCAC-0022N-032A	E106658-1	32A			80	28	25	12	27	17	M5	M12	12.3	-	0.25
FTCAC-0022N-063A	E109749-1	63A			98	32	25	14	33	22	M6	M16	16.3	14.3	0.3
FTCAC-0022N-075A	E109750-1	75A			108	32	25	16	37	25	M8	M20	20.3	18.3	0.3
FTCAC-0033N-016A	E109751-1	16A	3.5	33	33	25	25	12	24	17	M4	M12	12.3	-	0.2
FTCAC-0033N-032A	E106659-1	32A			86	25	25	12	27	17	M5	M12	12.3	-	0.2
FTCAC-0033N-063A	E109752-1	63A			108	28	35	14	33	22	M6	M16	16.3	14.3	0.3
FTCAC-0033N-075A	E109753-1	75A			118	28	35	16	37	25	M8	M20	20.3	18.3	0.35
FTCAC-0047N-016A	E106660-1	16A	5.0	47	80	25	25	12	24	17	M4	M12	12.3	-	0.2
FTCAC-0047N-032A	E106661-1	32A			86	25	25	12	27	17	M5	M12	12.3	-	0.2
FTCAC-0047N-063A	E106662-1	63A			108	28	35	14	33	22	M6	M16	16.3	14.3	0.3
FTCAC-0047N-075A	E109754-1	75A			118	28	35	16	37	25	M8	M20	20.3	18.3	0.35
FTCAC-0047N-100A	E106663-1	100A			118	28	35	16	37	25	M8	M20	20.3	18.3	0.35
FTCAC-0100N-016A	E106664-1	16A	10.0	100	80	32	25	14	24	22	M4	M16	16.3	14.3	0.3
FTCAC-0100N-032A	E106665-1	32A			86	32	25	14	27	22	M5	M16	16.3	14.3	0.3
FTCAC-0100N-063A	E106666-1	63A			108	32	35	14	33	22	M6	M16	16.3	14.3	0.4
FTCAC-0100N-075A	E106667-1	75A			118	32	35	16	37	25	M8	M20	20.3	18.3	0.45
FTCAC-0100N-100A	E106668-1	100A			118	32	35	16	37	25	M8	M20	20.3	18.3	0.45
FTCAC-0100N-150A	E109755-1	150A			134	38	35	19	45	32	M10	M24	24.3	22.3	0.55
FTCAC-0100N-200A	E109756-1	200A	134	38	35	19	45	32	M10	M24	24.3	22.3	0.55		
FTCAC-0220N-010A	E110074-1	10A	25.0	220	88	38	35	12	24	13	M3	M12	12.3	-	0.45
FTCAC-0220N-016A	E109757-1	16A			90	38	35	14	24	24	M4	M16	16.3	14.3	0.45
FTCAC-0220N-032A	E109758-1	32A			96	38	35	14	27	24	M5	M16	16.3	14.3	0.45
FTCAC-0220N-063A	E109759-1	63A			117	38	44	14	33	24	M6	M16	16.3	14.3	0.55
FTCAC-0220N-075A	E109760-1	75A			127	38	44	16	37	27	M8	M20	20.3	18.3	0.6
FTCAC-0220N-100A	E109761-1	100A			127	38	44	16	37	27	M8	M20	20.3	18.3	0.6
FTCAC-0220N-150A	E109762-1	150A			143	38	44	19	45	32	M10	M24	24.3	22.3	0.7
FTCAC-0220N-200A	E106669-1	200A			143	38	44	19	45	32	M10	M24	24.3	22.3	0.7

Model Number	Part Number	Current Rating @60°C	Leakage Current (mA) @250 VAC/50Hz	Capacitance (nF)±20%	A	B	C	D	E	F	T1	T2	M	N	Approx Weight (kg)
FTCAC-0470N-010A	E110075-1	10A	50.0	470	104	32	50	12	23	17	M3	M12	12.3	-	0.5
FTCAC-0470N-016A	E110076-1	16A			108	32	50	12	25	17	M4	M12	12.3	-	0.5
FTCAC-0470N-032A	E110077-1	32A			124	32	60	14	25	22	M5	M16	16.3	14.3	0.55
FTCAC-0470N-063A	E106670-1	63A			143	32	70	14	33	22	M6	M16	16.3	14.3	0.6
FTCAC-0470N-075A	E106671-1	75A			153	32	70	16	37	25	M8	M20	20.3	18.3	0.7
FTCAC-0470N-100A	E106672-1	100A			153	32	70	16	37	25	M8	M20	20.3	18.3	0.7
FTCAC-0470N-150A	E109763-1	150A			174	38	75	19	45	32	M10	M24	24.3	22.3	1
FTCAC-0470N-200A	E106673-1	200A			174	38	75	19	45	32	M10	M24	24.3	22.3	1
FTCAC-1000N-010A	E110078-1	10A	100.0	1000	115	32	60	12	24	17	M3	M12	12.3	-	0.55
FTCAC-1000N-016A	E110079-1	16A			115	32	60	12	25	17	M4	M12	12.3	-	0.55
FTCAC-1000N-032A	E110080-1	32A			130	32	70	14	25	22	M5	M16	16.3	14.3	0.6
FTCAC-1000N-063A	E106674-1	63A			143	38	70	14	33	24	M6	M16	16.3	14.3	0.9
FTCAC-1000N-075A	E106675-1	75A			153	38	70	16	37	27	M8	M20	20.3	18.3	0.9
FTCAC-1000N-100A	E106676-1	100A			153	38	70	16	37	27	M8	M20	20.3	18.3	0.9
FTCAC-1000N-150A	E109764-1	150A			174	38	75	19	45	32	M10	M24	24.3	22.3	1
FTCAC-1000N-200A	E106677-1	200A			174	38	75	19	45	32	M10	M24	24.3	22.3	1
FTCAC-2200N-010A	E110081-1	10A	210.0	2200	115	32	60	12	23	17	M3	M12	12.3	-	0.55
FTCAC-2200N-016A	E110082-1	16A			118	32	60	14	24	22	M4	M16	16.3	14.3	0.55
FTCAC-2200N-032A	E110083-1	32A			130	38	70	14	25	24	M5	M16	16.3	14.3	0.9
FTCAC-2200N-063A	E106678-1	63A			143	38	70	14	33	24	M6	M16	16.3	14.3	0.9
FTCAC-2200N-075A	E109765-1	75A			153	38	70	16	37	27	M8	M20	20.3	18.3	0.9
FTCAC-2200N-100A	E106679-1	100A			153	38	70	16	37	27	M8	M20	20.3	18.3	0.9
FTCAC-2200N-150A	E109766-1	150A			174	57	75	19	43	40	M10	M24	24.3	22.3	2
FTCAC-2200N-200A	E106680-1	200A			174	57	75	19	43	40	M10	M24	24.3	22.3	2
FTCAC-3300N-010A	E110084-1	10A	320.0	3300	125	57	70	14	22	24	M3	M16	16.3	14.3	2
FTCAC-3300N-016A	E110085-1	16A			125	57	70	14	24	24	M4	M16	16.3	14.3	2
FTCAC-3300N-032A	E110086-1	32A			130	57	70	14	25	24	M5	M16	16.3	14.3	2
FTCAC-3300N-063A	E109767-1	63A			145	57	70	16	33	27	M6	M20	20.3	18.3	2
FTCAC-3300N-075A	E109768-1	75A			153	57	70	16	37	27	M8	M20	20.3	18.3	2
FTCAC-3300N-100A	E109769-1	100A			153	57	70	16	37	27	M8	M20	20.3	18.3	2
FTCAC-3300N-150A	E109770-1	150A			174	57	75	19	43	40	M10	M24	24.3	22.3	2
FTCAC-3300N-200A	E109771-1	200A			174	57	75	19	43	40	M10	M24	24.3	22.3	2
FTCAC-4700N-010A	E110087-1	10A	450.0	4700	125	57	70	14	22	24	M3	M16	16.3	14.3	2
FTCAC-4700N-016A	E110088-1	16A			125	57	70	14	24	24	M4	M16	16.3	14.3	2
FTCAC-4700N-032A	E110089-1	32A			130	57	70	14	25	24	M5	M16	16.3	14.3	2
FTCAC-4700N-063A	E106681-1	63A			145	57	70	16	33	27	M6	M20	20.3	18.3	2
FTCAC-4700N-075A	E109772-1	75A			153	57	70	16	37	27	M8	M20	20.3	18.3	2
FTCAC-4700N-100A	E106682-1	100A			153	57	70	16	37	27	M8	M20	20.3	18.3	2
FTCAC-4700N-150A	E109773-1	150A			174	57	75	19	43	40	M10	M24	24.3	22.3	2
FTCAC-4700N-200A	E106683-1	200A			174	57	75	19	43	40	M10	M24	24.3	22.3	2

All dimensions are in mm.

Mechanical Drawing:

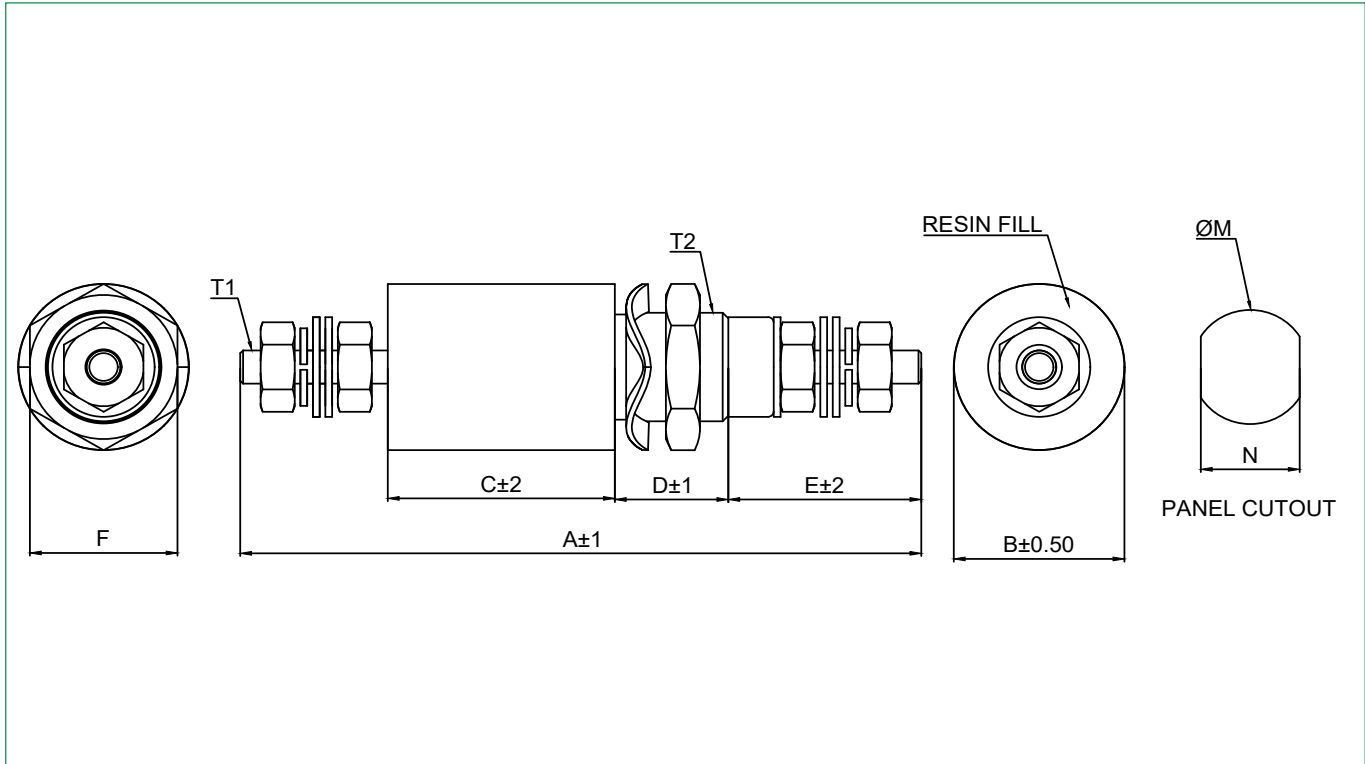

Typical Insertion Loss (At 50Ω)

Capacitance(nF)	Frequency (Hz)	0.03M	0.1M	1M	10M	100M	1G
2.2	Attenuation in dB	-	-	-	8	38	45
4.7		-	-	-	14	43	60
10		-	-	3	21	45	70
22		-	-	6	25	45	70
33		-	-	12	30	48	70
47		-	2	15	34	50	80
100		2	5	20	40	65	80
220		4	11	27	45	80	80
470		9	16	33	33	80	80
1000		15	22	40	42	80	80
2200		20	30	45	47	85	90
3300		30	40	50	52	85	90
4700		38	40	52	57	85	90

Torque Details

	M3	M4	M5	M6	M8	M10	M10X1	M12X1	M16X1	M20X1	M24X1
Terminal thread	0.5Nm	1.2Nm	1.8Nm	3Nm	6Nm	10Nm	----	----	----	----	----
Mounting thread	----	----	----	----	----	----	10Nm	14Nm	25Nm	36Nm	50Nm