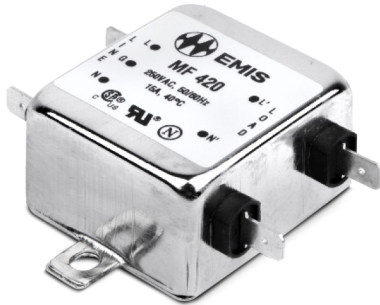

Features:

- Rated Current up to 125A
- Chassis mounting

Applications:

- Power Systems
- Electronic Equipments
- Frequency convertors
- Stepper motor drives
- UPS/Inverters

DATA SHEET
SINGLE PHASE EMI FILTER - MF420
Performance Indicator

Standard	High	Very High
█		

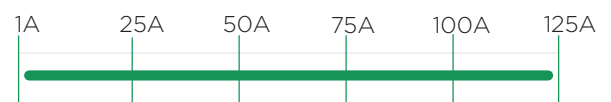
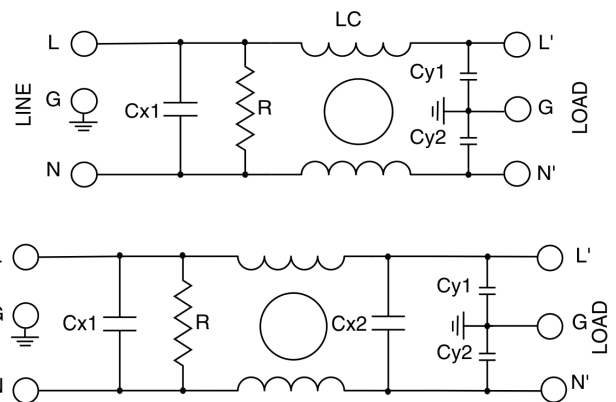
Rated current [A]

Typical circuit Diagram

For 20A & above

Description

These series range of General Purpose filters are designed to suppress undesirable electrical disturbances in Power Lines. They limit the amplitude of interfering voltages on AC power lines and prevent them from propagating into or out of the filtered equipment.

Technical Specifications:

Maximum Continuous Operating Voltage	: 250VAC, 50/60Hz(UL Approval) 250VDC
Operating Frequency	: DC to 400Hz
Current ratings	: 1A to 125A @40°C
High Potential test voltage	: L to G 2250Vdc for 1 Minute L to L 1450Vdc for 1 Minute
Overload Capability	: 135% of Rated current for 15 minutes
Design Corresponding to	: UL 60939-3, CSA 22.2 No.8-13 and IEC 60939-1&2
Flammability corresponding to	: UL 94 V-0
Temperature range	: -25°C to +85°C
Climatic Category	: 25/85/21

Ordering Information

Model Number	Part Number	Rated Current @40°C	Leakage Current (mA) @250VAC/50Hz	Termination		Weight (Grams)
						
MF 420	E100036-2	1A	0.34	6.3 x 0.8		60
MF 420	E100036-3	2A*	0.34	6.3 x 0.8		60
MF 420	E100036-4	3A	0.34	6.3 x 0.8		60
MF 420	E100036-5	6A	0.34	6.3 x 0.8		60
MF 420	E100036-6	10A	0.34	6.3 x 0.8		60
MF 420	E100036-7	15A	0.34	6.3 x 0.8		120
MF 420	E100036-8	16A*	0.34	6.3 x 0.8		120
MF 420	E100036-9	20A	0.34	6.3 x 0.8		200
MF 420	E100036-10	25A*	0.73		M5	650
MF 420	E100036-11	30A	0.73		M5	650
MF 420	E100036-12	35A*	0.73		M5	650
MF 420	E100036-13	40A	0.73		M5	650
MF 420	E100036-14	50A	0.73		M6	1000
MF 420	E100036-15	60A*	0.73		M8	1000
MF 420	E100036-16	75A*	0.73		M8	2000
MF 420	E100036-17	80A*	0.73		M8	2000
MF 420	E100036-18	100A*	0.73		M10	2000
MF 420	E100036-19	125A*	0.73		M10	2000

Note: * Not covered under NEMKO

Mechanical Drawing:

1A-10A

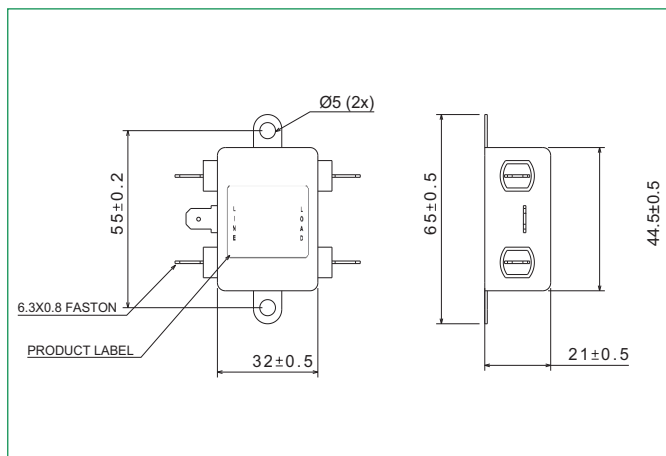

15A-16A

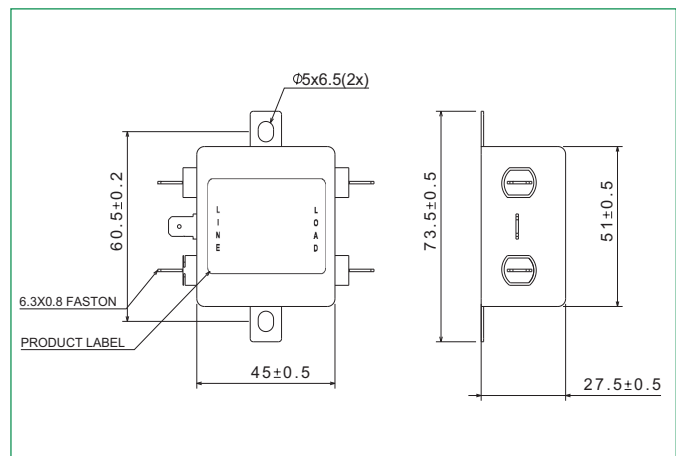

20A

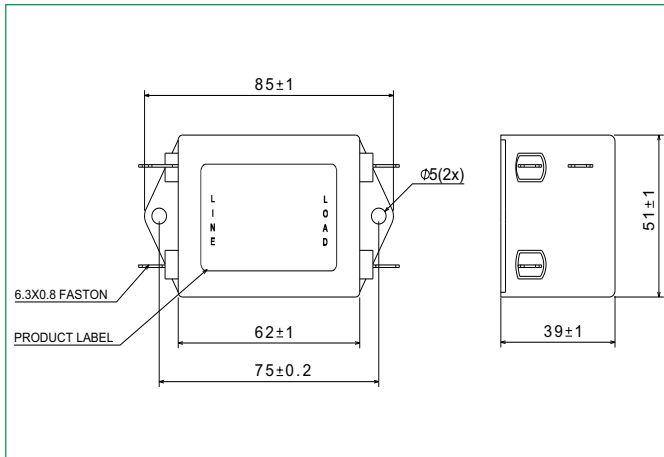

25A-40A

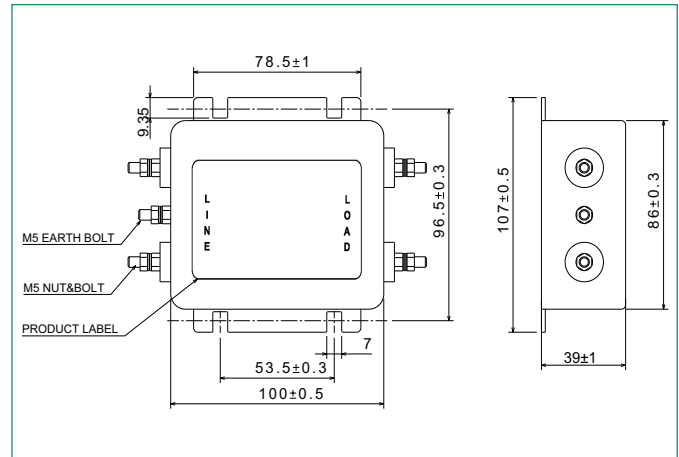

50A-60A

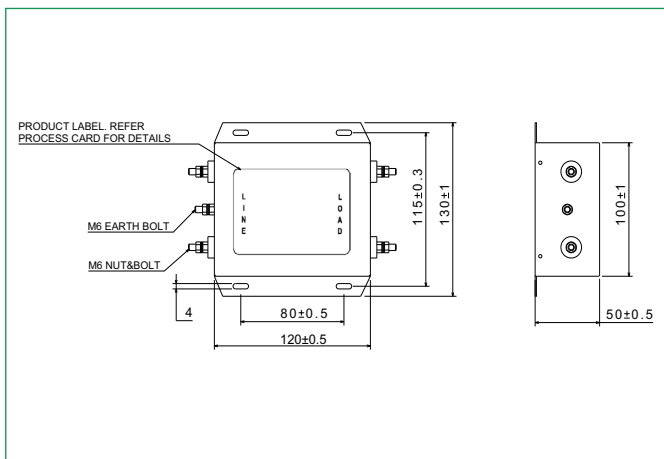

75A-125A

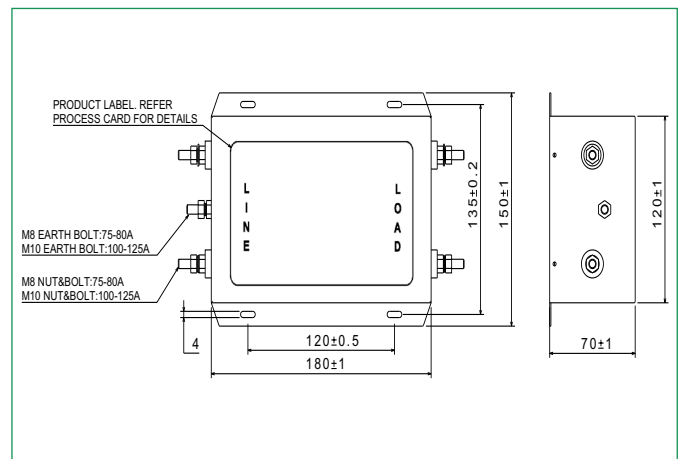

Thread	M5	M6	M8	M10
Recommended Torque (Nm)	2.0-2.2	3.5-4.0	8.0-9.0	15.0-17.0
Earth terminal (Nm)	2.0-2.2	3.5-4.0	8.0-9.0	15.0-17.0

Note: All dimensions in mm; Tolerances according to ISO2768-C

Insertion Loss : Common mode _____ Differential Mode

Per CISPR 17; DM=50/50 sym; CM=50/50 asym

1A

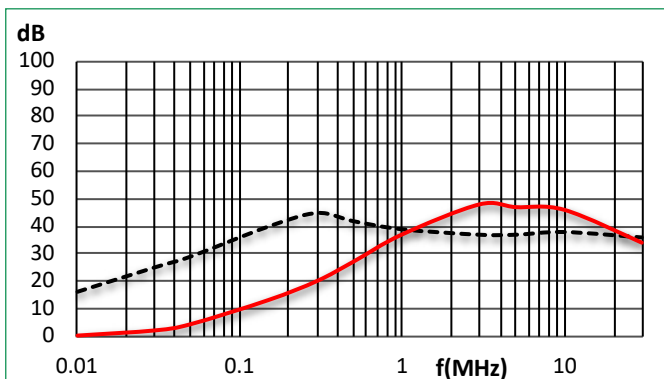

2A

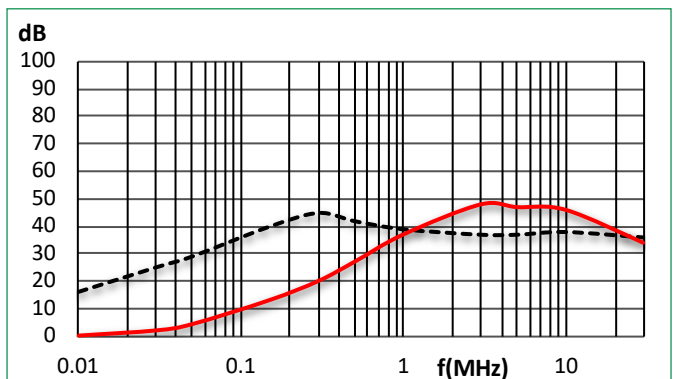

3A

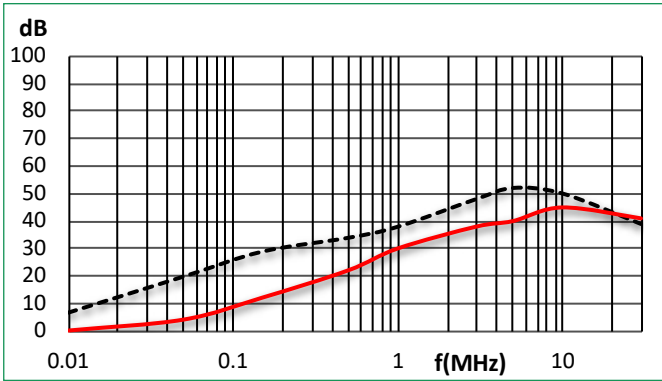

6A

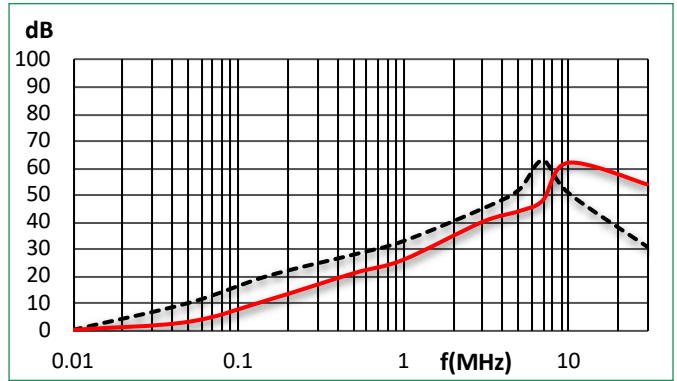

10A

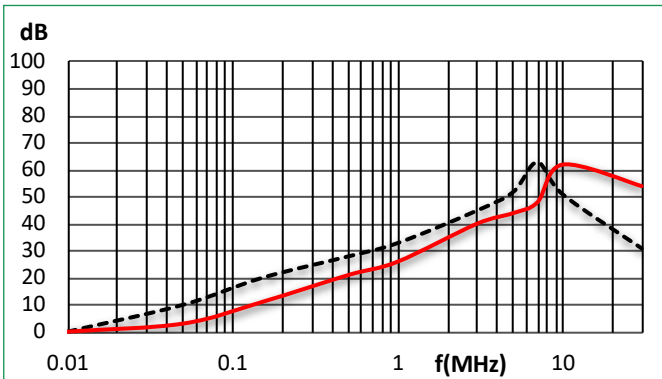

15A

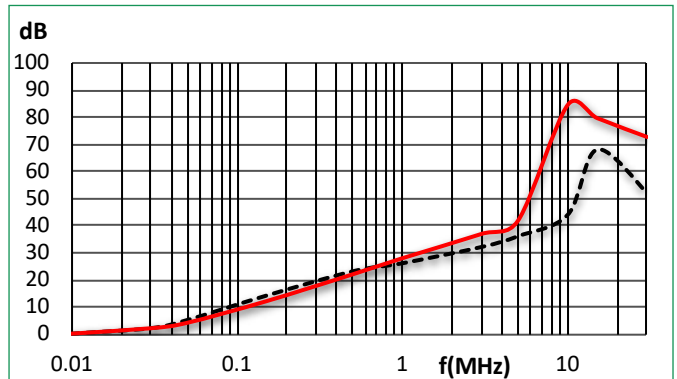

16A

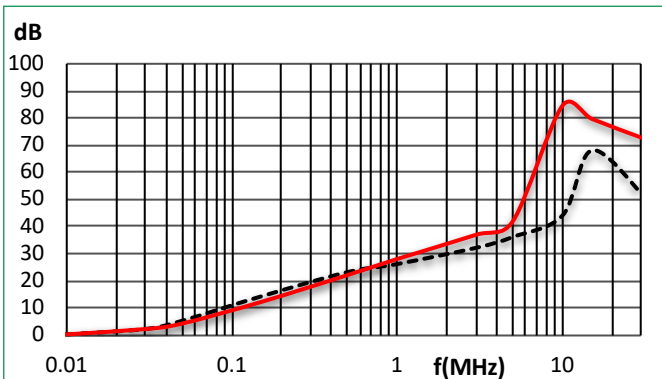

20A

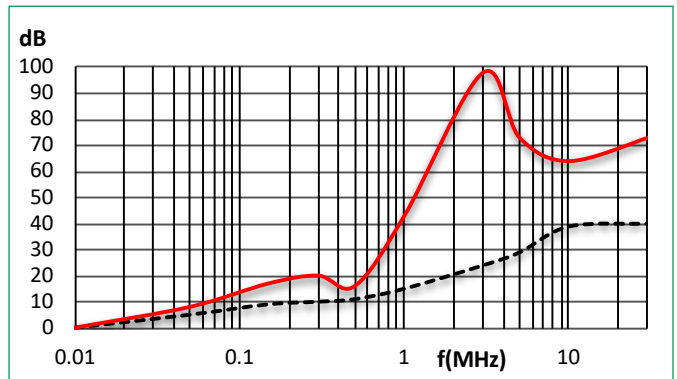

25A

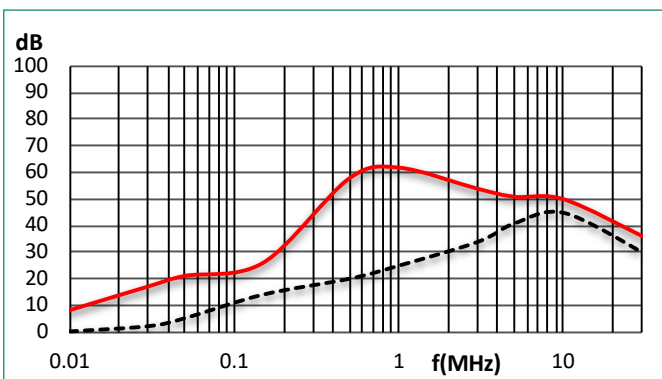

30A

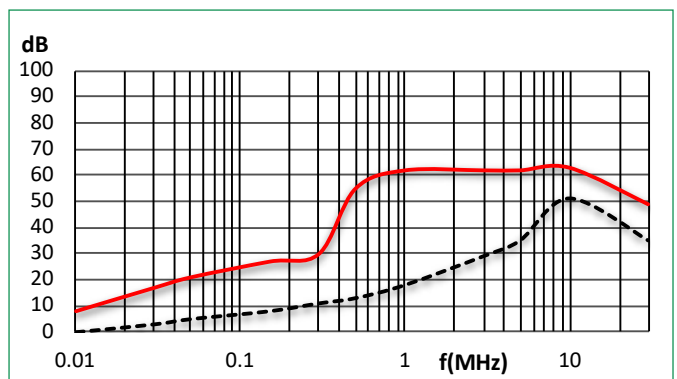

40A

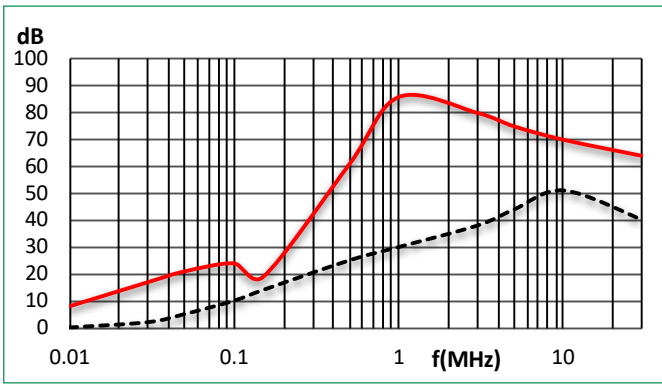

50A

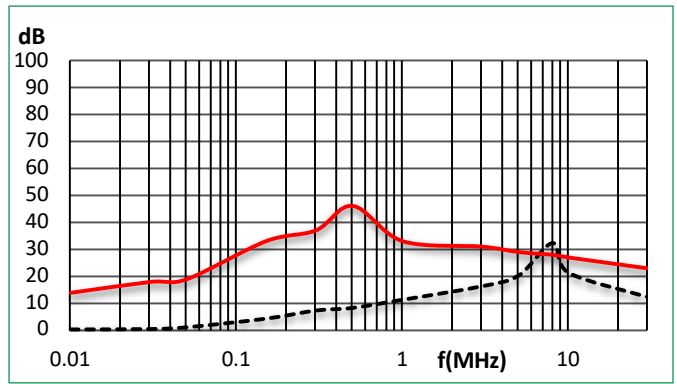

60A

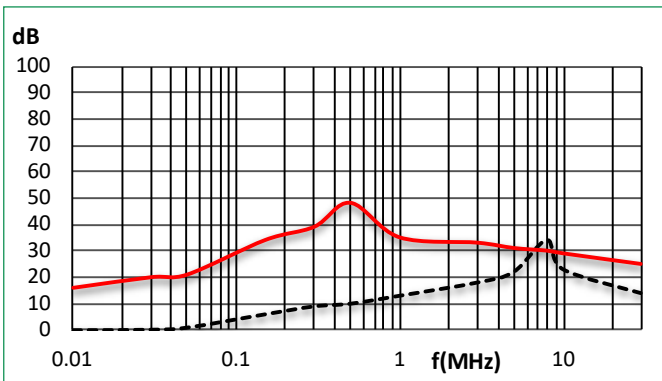

75A

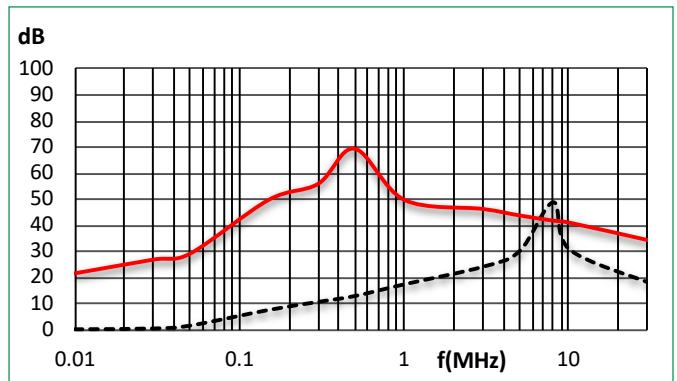

80A

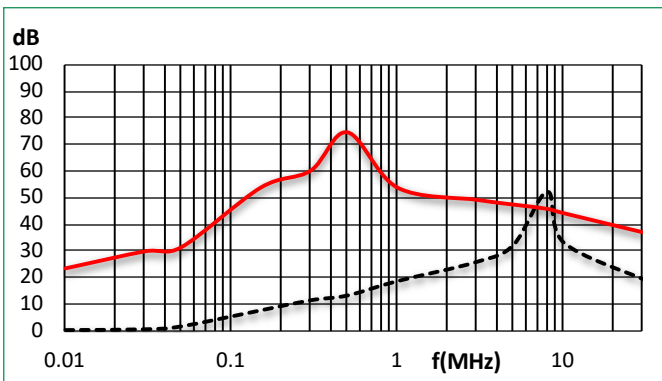

100A

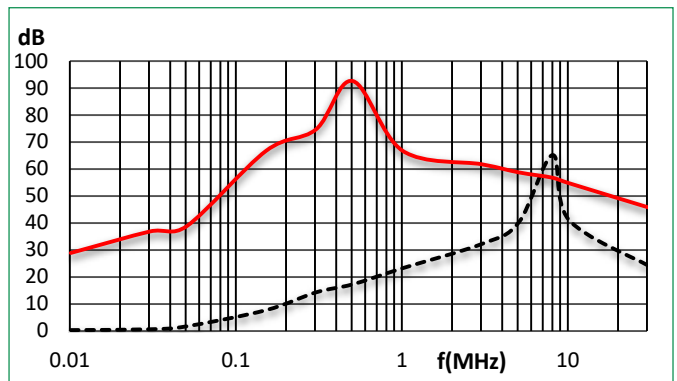

125A

