

Features:

- Double stage filter
- Superior Performance
- Chassis mounting

Applications:

- Power Systems
- Electronic Equipment
- Frequency convertors
- Stepper motor drives
- UPS/Inverters

DATA SHEET
SINGLE PHASE EMI FILTER - MF410
Description

These series range of double stage filters give superior performance when used in applications with low Impedance loads controlling pulsed, continuous and intermittent interference noise and where high levels Of mains borne interference are present.

Performance Indicator

Rated current [A]

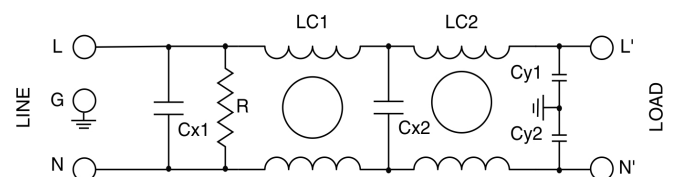
Typical circuit Diagram

Technical Specifications:

Maximum Continuous Operating Voltage	: 250VAC, 50/60Hz(UL Approval) 250VDC
Operating Frequency	: DC to 400Hz
Current ratings	: 1A to 100A @40°C
High Potential test voltage	: L to G 2250Vdc for 1 Minute L to L 1450Vdc for 1 Minute
Overload Capability	: 135% of Rated current for 15 minutes
Design Corresponding to	: UL 60939-3, CSA 22.2 No.8-13 and IEC 60939-1&2
Flammability corresponding to	: UL 94 V-0
Temperature range	: -25°C to +85°C
Climatic Category	: 25/85/21

Ordering Information

Model Number	Part Number	Rated Current @40°C	Leakage Current(mA) @250VAC	Termination		Weight (Grams)
						
MF 410	E100019-2	1A	0.34	6.3 x 0.8		120
MF 410	E100019-3	2A	0.34	6.3 x 0.8		120
MF 410	E100019-4	3A	0.34	6.3 x 0.8		170
MF 410	E100019-5	6A*	0.34	6.3 x 0.8		170
MF 410	E100019-6	10A	0.34	6.3 x 0.8		170
MF 410	E100019-7	15A	0.34	6.3 x 0.8		200
MF 410	E100019-8	20A	0.73		M5	650
MF 410	E100019-9	25A	0.73		M5	650
MF 410	E100019-10	30A	0.73		M5	650
MF 410	E100019-11	35A*	0.73		M5	1000
MF 410	E100019-12	40A	0.73		M5	1000
MF 410	E100019-13	50A	0.73		M6	2000
MF 410	E100019-14	60A*	0.73		M6	2000
MF 410	E100019-15	100A*	0.73		M8	2000

Note : *not covered under NEMKO

Mechanical Drawing:

1A to 2A

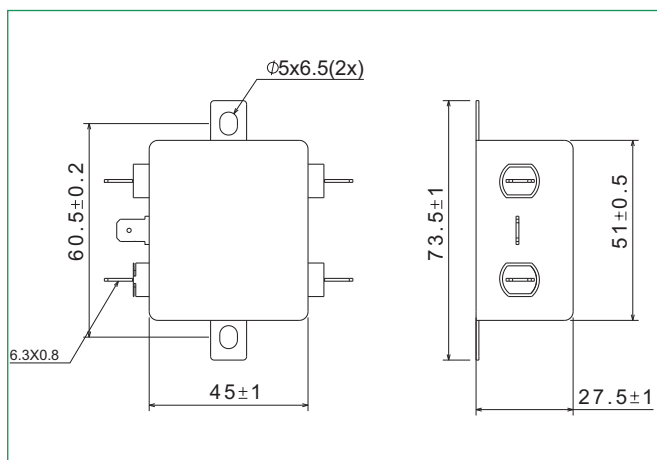

3A to 10A

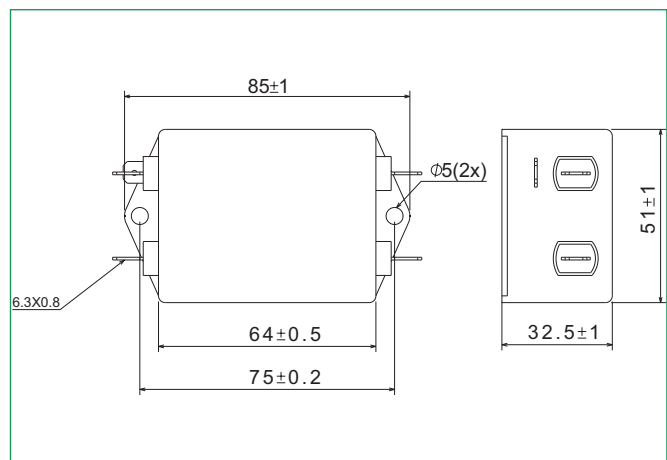

15A

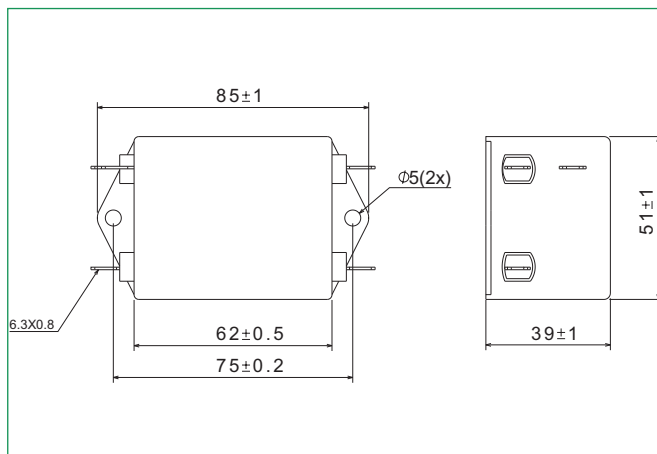

20A to 30A

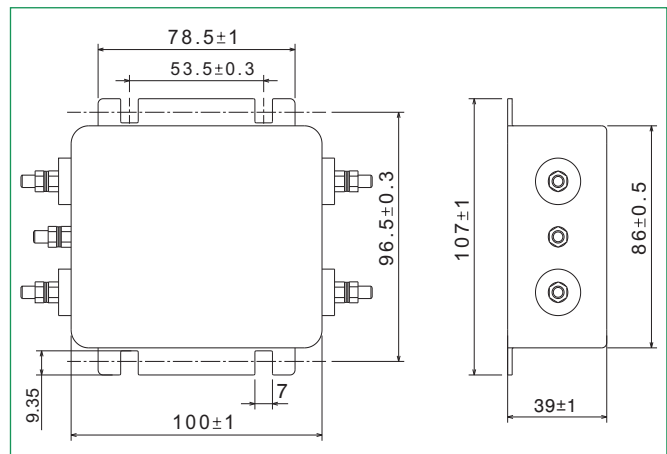

35A to 40A

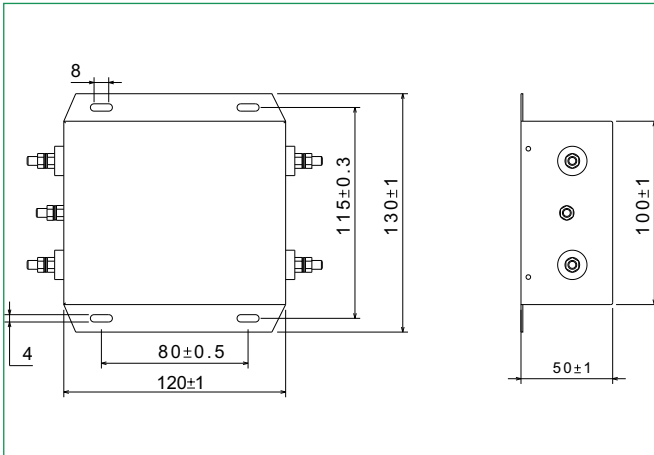

50A to 100A

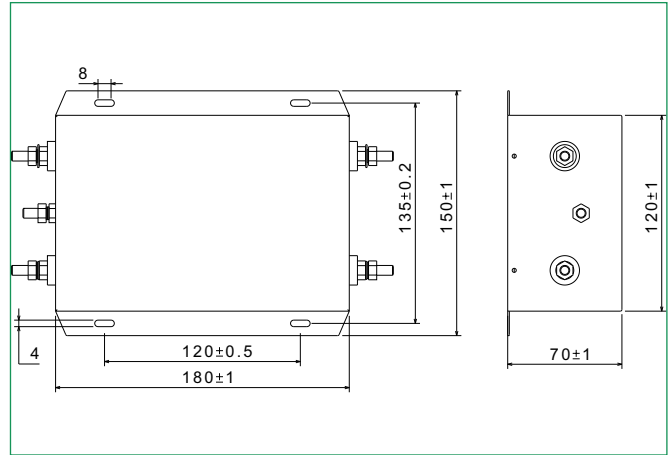

Thread Size	M5	M6	M8
Recommended Torque (Nm)	2-2.2	3.5-4	8-9
Earth Terminal (Nm)	2-2.2	3.5-4	8-9

Note: All dimensions in mm; Tolerances according to ISO2768-C

Insertion Loss : Common mode _____ Differential Mode

Per CISPR 17; DM=50/50 sym; CM=50/50 asym

1A

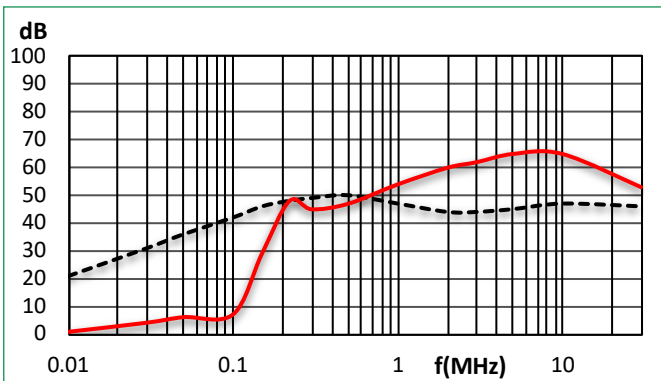

3A

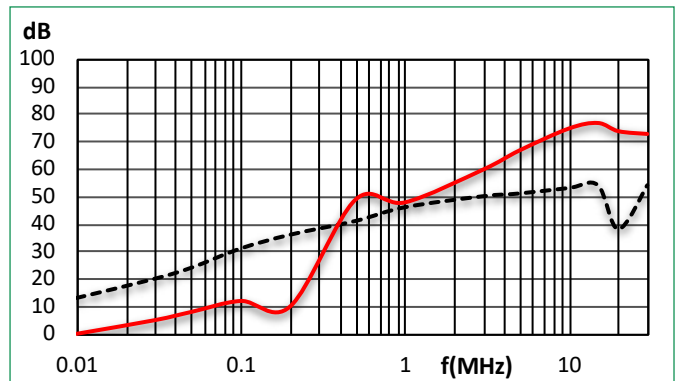

6A

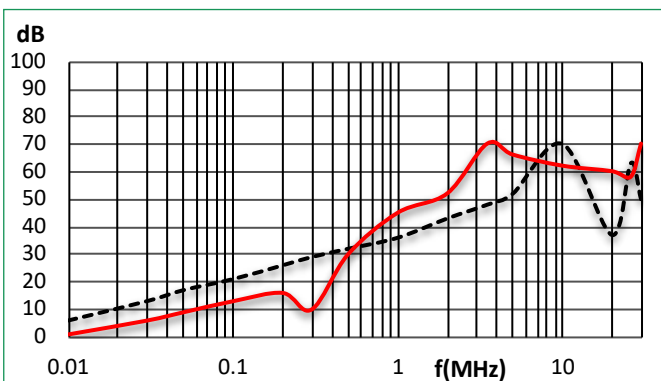

10A

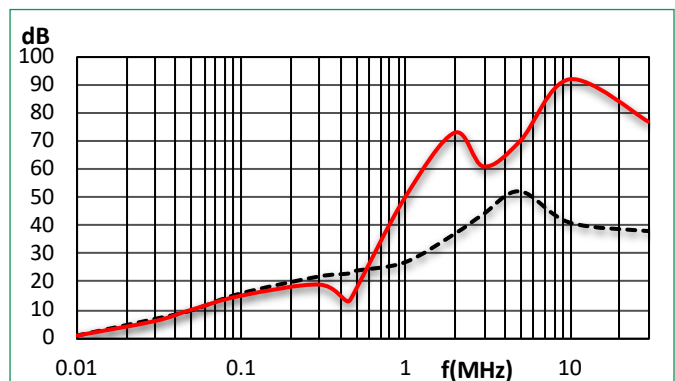

15A

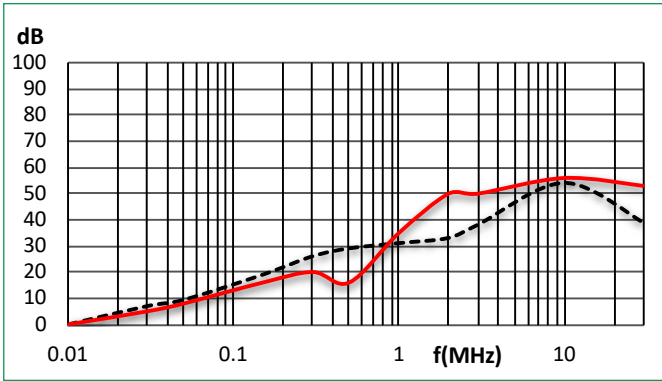

20A

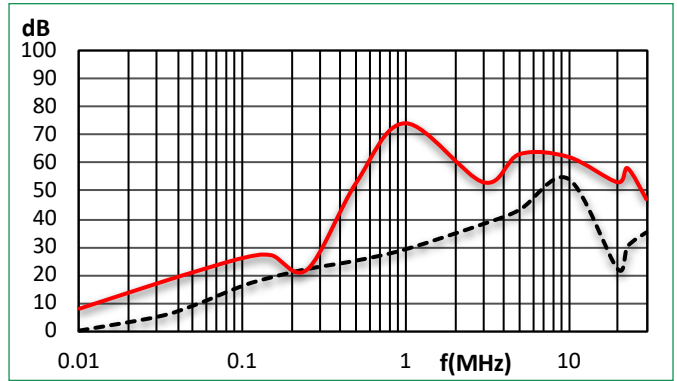

30A

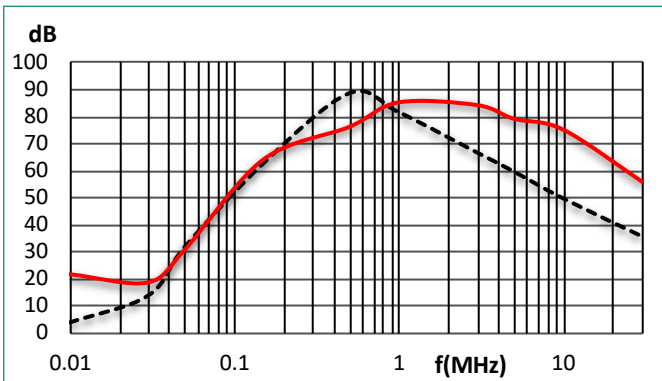

40A

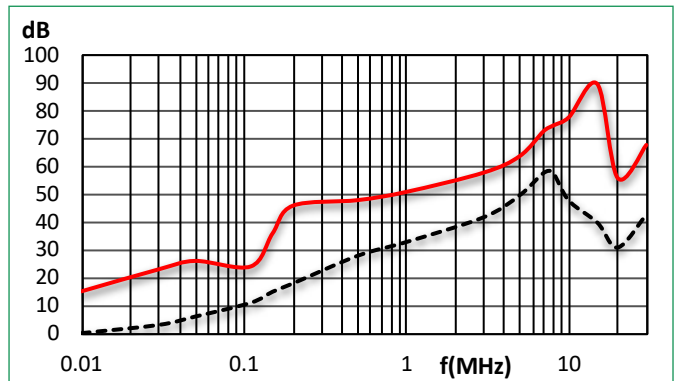

50A to 100A

