

Features:

- Double stage filter
- Ultra-low leakage current
- Superior Performance
- Chassis mounting

Applications:

- Power Systems
- Electronic Equipment
- Frequency convertors
- SMPS
- Escalators

Performance Indicator

Rated current [A]

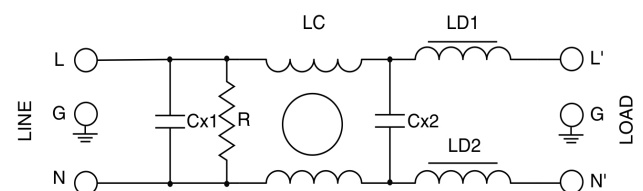
Typical circuit Diagram

DATA SHEET
**SINGLE PHASE EMI FILTER - MF 130
MEDICAL VERSION**
Description

Filter with additional differential mode rejection in low frequency with ultra-low leakage current suitable for medical applications meeting the requirements of medical Standards.

Technical Specifications:

Maximum Continuous Operating Voltage	: 250VAC, 50/60Hz(UL Approval) 250VDC
Operating Frequency	: DC to 400Hz
Current ratings	: 1A to 60A @40°C
High Potential test voltage	: L to G 2250Vdc for 1 Minute L to L 1450Vdc for 1 Minute
Overload Capability	: 135% of Rated current for 15 minutes
Design Corresponding to	: UL 60939-3, CSA 22.2 No.8-13
Flammability corresponding to	: UL 94 V-0
Temperature range	: -25°C to +85°C
Climatic Category	: 25/85/21

Ordering Information

Model Number	Part Number	Rated Current @40°C	Leakage Current (µA) @250VAC/50Hz	Termination		Weight (Grams)
						
MF 130	E101893-2	1A	<5	6.3 x 0.8		120
MF 130	E101893-3	2A	<5	6.3 x 0.8		120
MF 130	E101893-4	3A	<5	6.3 x 0.8		170
MF 130	E101893-5	6A	<5	6.3 x 0.8		170
MF 130	E101893-6	10A	<5	6.3 x 0.8		170
MF 130	E101893-14	12A*	<5		M5	650
MF 130	E101893-7	15A	<5		M5	650
MF 130	E101893-8	20A	<5		M5	650
MF 130	E101893-9	25A	<5		M5	650
MF 130	E101893-10	30A	<5		M5	650
MF 130	E101893-11	40A	<5		M5	1000
MF 130	E101893-12	50A	<5		M5	2000
MF 130	E101893-13	60A	<5		M5	2000

Note: * Not covered under UL.

Mechanical Drawing:

1A-2A

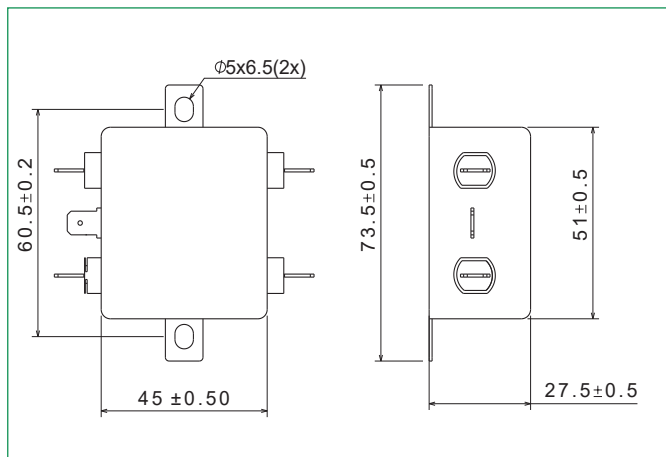

3A-6A

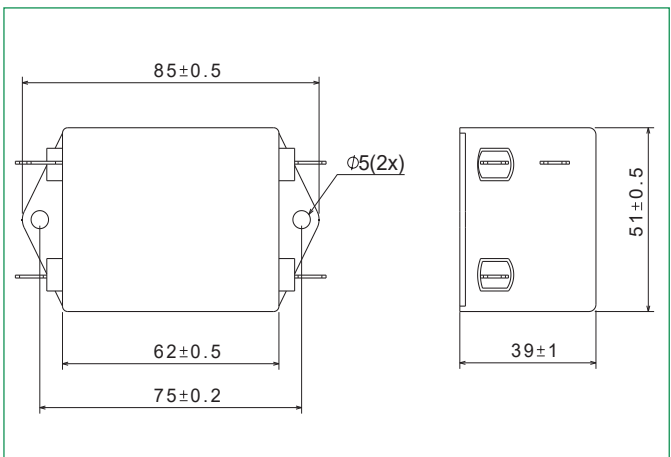

10A

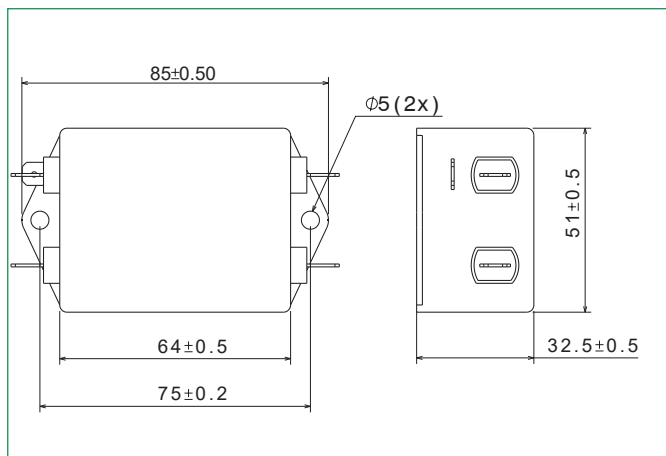

12A-20A

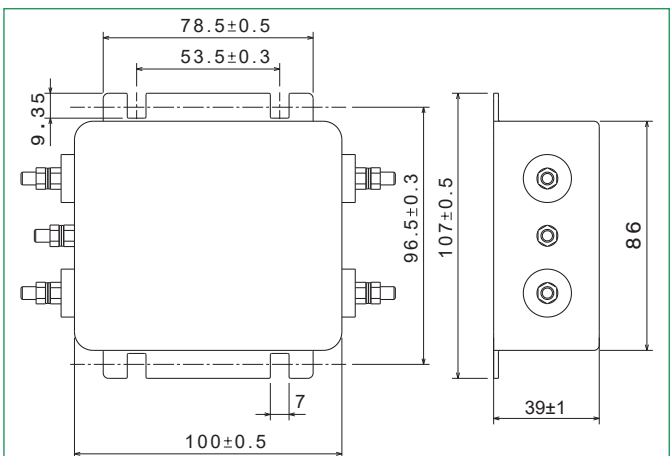

30A-40A

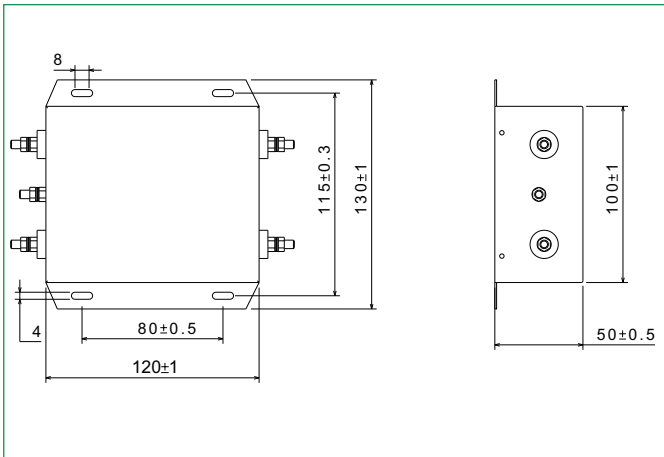

50A-60A

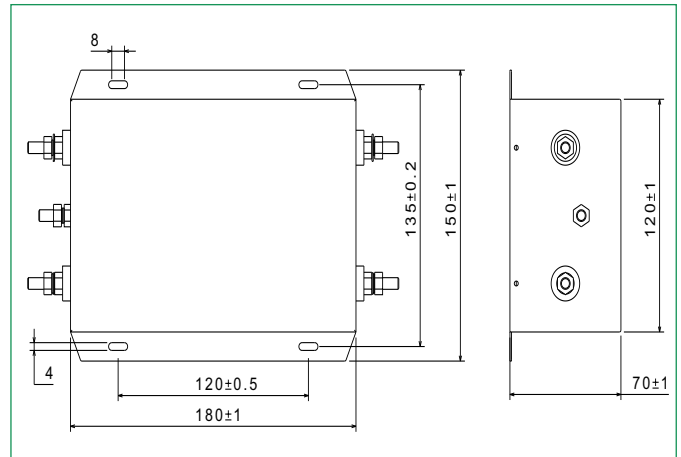

Bolt	M5	M6
Recommended Torque (Nm)	2-2.2	3.5 - 4
Earth terminal(Nm)	2-2.2	3.5 - 4

Note: All dimensions in mm; Tolerances according to ISO2768-C

Insertion Loss : Common mode _____ Differential Mode

Per CISPR 17; DM=50/50 sym; CM=50/50 asym

1A

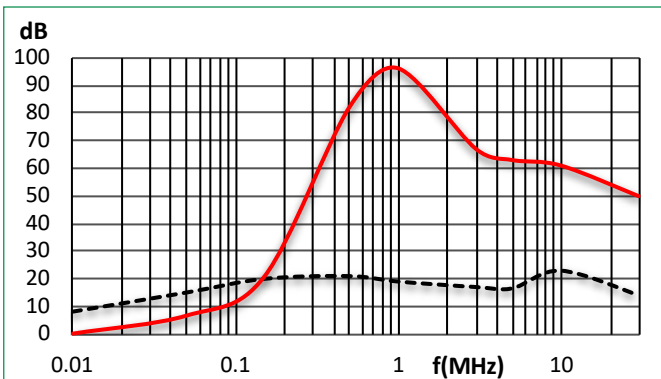

2A

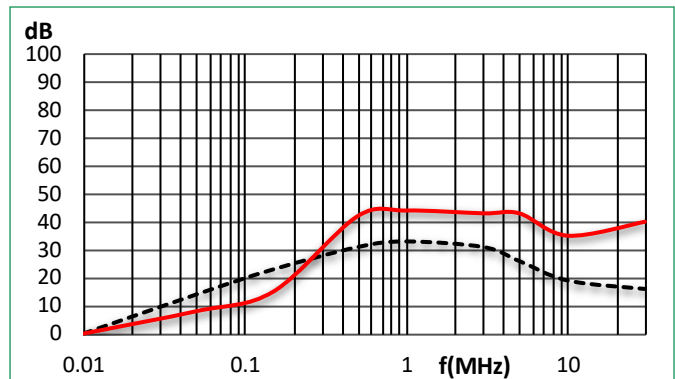

3A

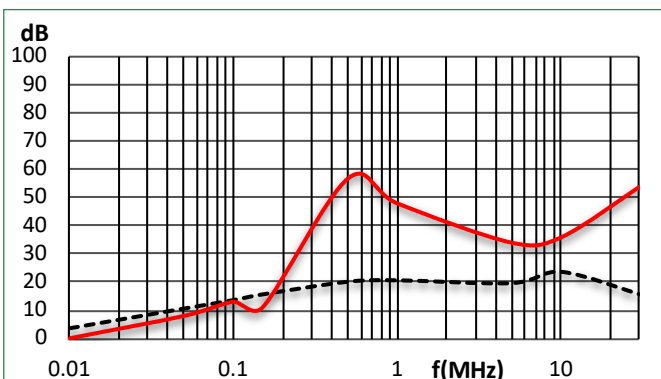

6A

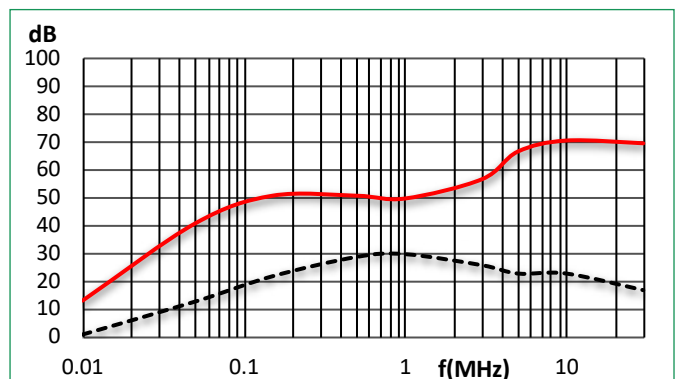

10A

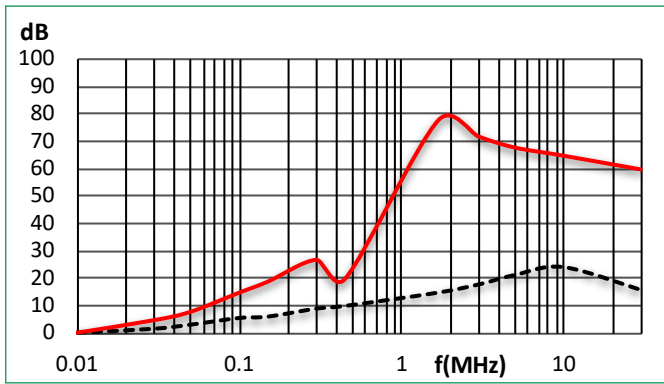

15A

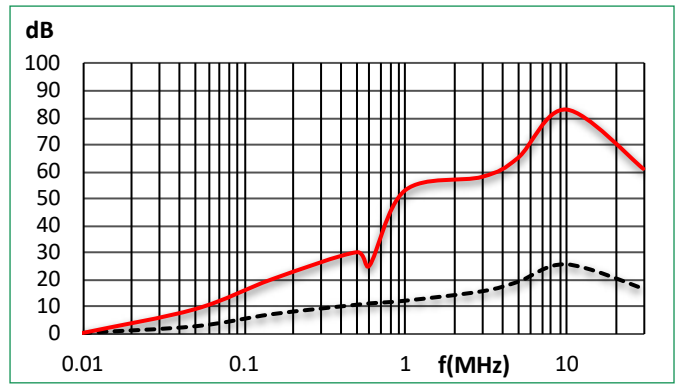

20A

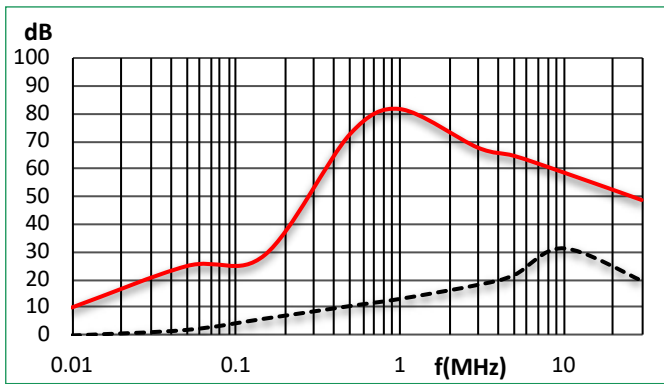

25A

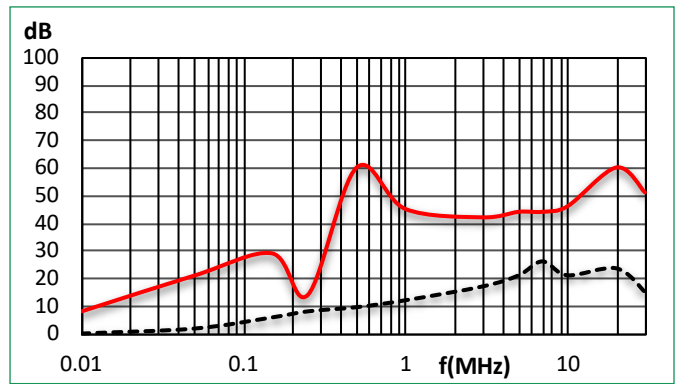

30A

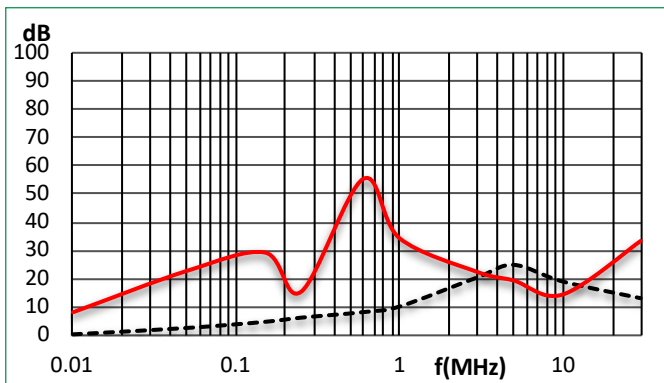

40A

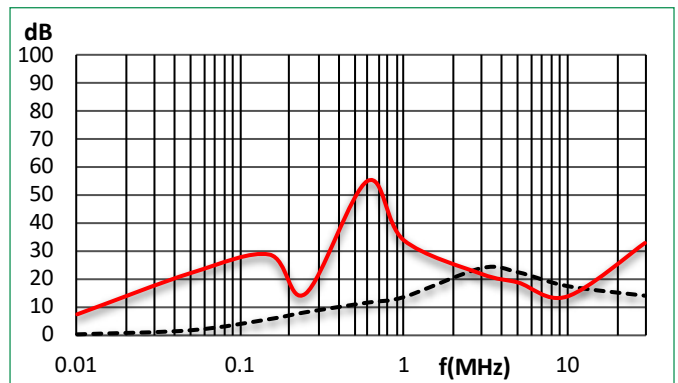

50A

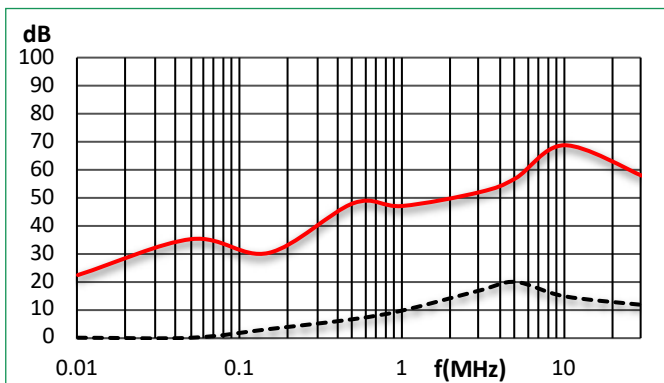

60A

