

**DATASHEET**

# COAXIAL EMP SURGE PROTECTOR

**Ordering Code Information**

| Model Number | Ordering code |
|--------------|---------------|
| EMISCOA100W  | EMP100NCA025G |

**Technical Specifications**

|                            |                                                  |
|----------------------------|--------------------------------------------------|
| Frequency                  | DC-2.5GHz                                        |
| Impedance                  | 50Ω                                              |
| Connector (Input & Output) | N(F)                                             |
| Input Power                | 100 Watt                                         |
| Insertion loss             | ≤0.5dB                                           |
| Return loss                | ≤20 dB                                           |
| Maximum Surge Current      | 18 kA, 8/20μs, Single Pulse                      |
| EMP Compliance             | As per MIL STD 188-125-1<br>(Charge Line Method) |
| Enclosure/Finish           | Brass/ Plated                                    |
| Weight                     | Approx.300g                                      |

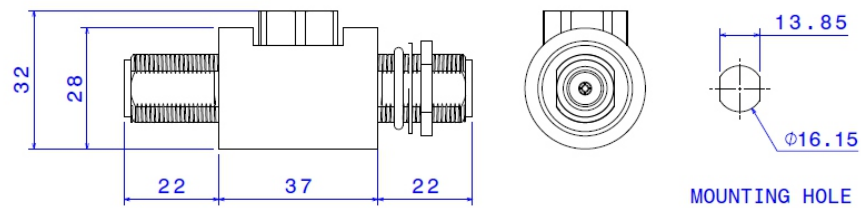
**Mechanical Dimensions**

**Accessories**

1. N(M) Dust Cap -2No's
2. Washer -2No's
3. Nut - 1No

